



Model 155L



Accessories



General representation



Fueling



Aviation
Fueling

Visual Position Indicator

Description

This device provides a clear view of the valve's position status. It consists of an adaptor threaded into the main valve bonnet, a rod threaded into the main valve stem, a sealed Pyrex sight glass, and protective stainless steel housing. The indicator rod moves as the main valve opens and closes.

Features & Benefits

- Designed specifically for military service valves utilizing jet fuel or Avgas service
- Includes an air release vent for reliable, effective air removal from the control loop; convenient for startups
- Can be installed without disassembly of the main valve
- Working pressure 400psi

Matrix

Item	Description	QTY	Material
1	Adaptor, Lower	1	SS
2	O-Ring, Inner Housing	2	FKM
3	Housing	1	SS
4	Gasket, Cushion	2	FKM
5	Sight Glass	1	PYREX
6	Adaptor, Upper	1	SS
7	Screw, Air Bleed	1	SS
8	Indicator Stem	1	MONEL
9	O-Ring, Outer Housing	2	FKM
10	Seal Washer, Air Bleed	1	FKM/SS

Schematic & Parts

The OCV 155L is shown on OCV 120-6 Rate of Flow Valve Schematic:

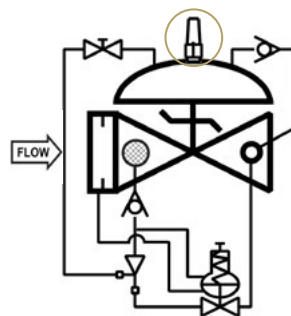

Order P/N 155L Assemble with Stem	Main Valve Size INCHES (MM)	Valve Stroke INCHES
255750	1.25 (32)	.375"
	1.5 (40)	
	2 (50)	.5"
	2.5 (65)	.75"
255751	3 (80)	1"
	4 (100)	1.375"
255752	6 (150)	1.5"
255753	8 (200)	2.5"
	10 (250)	3"
255754	12 (300)	3"
255755	14 (350)	3.5"
	16 (400)	4.3"

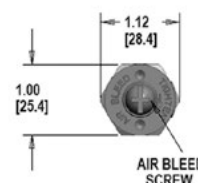
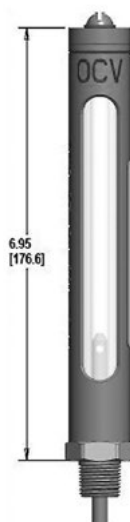
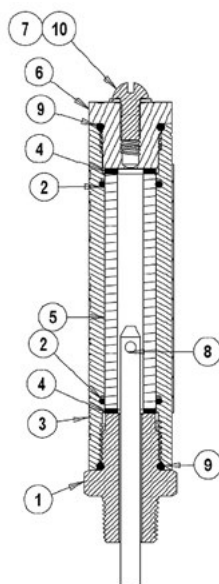

Aquestia Ltd. reserves the right to make product changes without prior notice. To ensure receiving updated information on parts specifications, please contact us at usa@aquestia.com. Aquestia Ltd. shall not be held liable for any errors. All rights reserved.

